

www.kbm.dk



Lost foam
molding

INJEKTORKING LS EPS, EPP, EPE, Neopor etc.

Injector fill gun 28, 30, 32, 33, 40, M42x1,5, 42 and 50 mm

Piston plunger: 8, 10, 12, 16, 18, 20 or 24 mm

Tip outside diameter: 10 - 26 mm (small plungers)

Tip outside diameter: 18 - 38mm (large plungers)

Fixed air consumption

READ AND SAVE MONEY:

- **General very low air consumption with high vacuum** for a good filling = saves energy = saves money!
- **Durable design with stainless steel** critical parts = very long life time = saves money!
- **Long life time of seals** = few production stops = saves money!
- **Easy and very fast maintenance** of seals when necessary = saves money!
- **Non-sensitive generation of vacuum** = constant filling rate with recycled material too = few production stops = saves money!
- **Easy quick-clamp solutions** = saves time = saves money!
- **Dismountable by hand** = saves time = saves money!



Optional with core vent



More sizes of plungers

3 different quick connector systems



Combi



Turbo/Combi



MULTI

Can you afford not to try?



KBM APS
DK 3400 HILLERØD
TLF.+45 4826 8090
Homepage: www.kbm.dk

VØLUNDSVEJ 13
DENMARK
FAX.+45 4826 8016
e-mail: kbm@kbm.dk



The INJEKTORKING LS INJECTOR FILLER for EPS, EPP etc. with long stroke offers the following advantages:

- Especially designed, also for use with pressure filling systems, allowing optimal filling, also of thin-walled sections.
- Very solid design with barrel, piston sleeve, piston shaft and feed pipe made of stainless steel.
- Low weight ensures that no parts are damaged due to the weight of the injector when it is mounted in the mould.
- Very simple construction and extremely little maintenance, with all parts to be dismantled by hand without using tools at all.
- Change of teflon U-seal takes only 1 minute (the only seal, which is influenced by the steam), also without use of tools. To change the only 3 wearparts (2 seals + 1 bushing) takes 5 minutes. No other parts to be changed.
- Built-in "blowback on time after closed" function.
- Quick clamp for material hose available (see small photo on front page).
- The INJEKTORKING LS is precalibrated for 120 l/min (4.25 CuFt/min) air consumption by 6 bar (87 PSI) pressure. This is equal to 317 nominal l/min (11.2 CuFt/min).

TYPES	A	B	C	D	E
8 mm piston plunger:					
200/BB/10-26/08	200mm	M28x1,0 28, 30, 32, 33, 40, 42, 50 mm	10-26mm	8mm	390mm
300/BB/10-26/08	300mm	M28x1,0 28, 30, 32, 33, 40, 42, 50 mm	10-26mm	8mm	490mm
400/BB/10-26/08	400mm	M28x1,0 28, 30, 32, 33, 40, 42, 50 mm	10-26mm	8mm	690mm
10 mm piston plunger:					
200/BB/12-26/10	200mm	M28x1,0 28, 30, 32, 33, 40, 42, 50 mm	12-26mm	10mm	390mm
300/BB/12-16/10	300mm	M28x1,0 28, 30, 32, 33, 40, 42, 50 mm	12-26mm	10mm	490mm
400/BB/12-26/10	400mm	M28x1,0 28, 30, 32, 33, 40, 42, 50 mm	12-26mm	10mm	590mm
12 mm piston plunger:					
200/BB/14-26/12	200mm	M28x1,0 28, 30, 32, 33, 40, 42, 50 mm	14-26mm	12mm	390mm
300/BB/14-26/12	300mm	M28x1,0 28, 30, 32, 33, 40, 42, 50 mm	14-26mm	12mm	490mm
400/BB/14-26/12	400mm	M28x1,0 28, 30, 32, 33, 40, 42, 50 mm	14-26mm	12mm	690mm
16 mm piston plunger:					
200/BB/18-26/16	200mm	M28x1,0 28, 30, 32, 33, 40, 42, 50 mm	18-26mm	16mm	545mm
200/BB/18-26/16/110* (with ejector)	200mm	M28x1,0 28, 30, 32, 33, 40, 42, 50 mm	18-26mm	16mm	820mm
300/BB/18-26/16	300mm	M28x1,0 28, 30, 32, 33, 40, 42, 50 mm	18-26mm	16mm	745mm
300/BB/18-26/16/110* (with ejector)	300mm	M28x1,0 28, 30, 32, 33, 40, 42, 50 mm	18-26mm	16mm	1020mm
16, 18, 20 and 24mm piston plunger:					
230/BB/18-38/DD	230mm	40, 42, 50 mm	18-38mm	16, 18, 20, 24mm	
330/BB/18-38/DD	330mm	40, M42x1,5 42, 50 mm	18-38mm	16, 18, 20, 24mm	
430/BB/18-38/DD	430mm	40, M42x1,5 42, 50 mm	18-38mm	16, 18, 20, 24mm	
530/BB/18-38/DD	530mm	40, 42, 50 mm	18-38mm	16, 18, 20, 24mm	

*Built-in 110 mm ejector movement.

Special lengths also available on request.

Feed pipes for 22mm (7/8").
3 different types of Quick clamps.
Dimensions: 22 (7/8"), 25 (1") or 32mm (1 1/4") material hose.

Injektorking LS with built-in ejector



Optional with steam core vent



A version with non-rotating plunger is available too.

It can be shaped to fit the contours of the mould. A "Contour filler".



Threaded barrel with M28 x 1.0 thread and nut

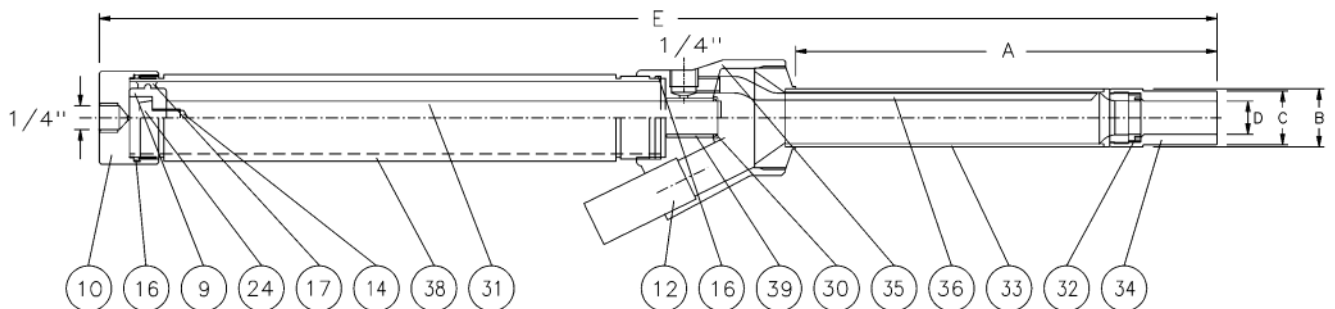

INJEKTORKING LS (basic model)

Subject to alterations

9. Piston	16. O-ring	31. Piston plunger	35. Casing	Quick clamp:
10. Air cylinder cap	17. Double lip seal	32. U-seal (teflon)	36. Blow pipe	60. Clip
12. Feed pipe	24. Set screw M8x30	33. Outside barrel	38. Air cylinder	61. Hose stub
14. 2x Nut M8	30. Allen screw M6x8	34. Tip	39. Bearing	62. Connecting piece.